FORWARD CABINS

- 1 Double bed (6'7" x 4'6" x 3'10' / 2m x 1.36m x 1.16m)
- 1 Hanging locker - 2 Closed high shelves, 1 Open shelving, 1 Drawer under the bed
- 2 Swivelling reading lights
- 1 Deck hatch with mosquito screen/blind
- 1 Hull porthole with sliding blind
- 1 USB socket
- Access door to the head

FORWARD HEADS

- Headroom: 6'1" / 1.85m
- Access from the cabin
- Shower area accessible by swivelling the washbasin, 2 Mirrors, Toilet accessories, 1 Opening portlight with curtains in the coachroof side window

AFT CABINS

- Headroom: 1,97 m / 6'6"
- Double bed (2,10 m x 1,60 m / 6'11" x 5'3")=
- 1 Drawer under the bed 1 Hanging locker - 1 Cupboard - Closed cubbyholes
- 1 Bed access sideboard
- 2 Flexible and multi-directional reading lights at headboard
- 1 USB socket
- 1 Hull porthole with sliding blind
- 1 Cockpit opening window with curtain under cockpit seats
- 1 Fixed cockpit window with curtain on the coaming

AFT HEADS

- Aft Heads Headroom: 6'1" / 1.85m
- Access from the saloon or the aft cabins
- Shower area accessible by swivelling the washbasin
- Toilet accessories
- 2 Mirrors
- 1 Opening portlight with curtains in the coachroof side window

-
- Rotomolded freshwater tank 440L / 116us gal, under berth in forward cabin - 1 Deck filler
 - t = = b = i = =
 - Mi=L=NN=rp=d =b = = =E = F
 - b = = =
 - N=b = =
 - N=j = =
 - N=b = = = = = =
 - **Watermaker**
 - **Electric flushing toilets throughout, including bow cabin**

bkdfkb=C= lkqolip

- **Yanmar 4JH110 CR 81Kw (110HP) Diesel**
- **Port and starboard helm stations**
- Engine throttle and control panel on starboard
- Engine compartment: Soundproofing foam - Ventilation: 3 air intakes and 1 forced air outlets 1 Alternator 12v / 125 Amp
- 1 Rotomolded diesel tank 200 L / 53 US Gal (under starboard aft berth) - Electronic gauge - Low level alarm - 1 Deck filler
- Extra 200L / 53us gal fuel tank
- Filters: Sea water - Diesel - Water separator
- Fixed three blade propeller
- 1 Engine access through companionway (opening with 2 gas pistons) - 2 Engine access through aft cabins
- Bowthruster

ELECTRICAL INSTALLATION

- 12 V Circuit
- 2 Service batteries (140 Amp) - 1 Engine battery (120 Amp)
- **AGM batteries & 40ah battery charger**
- 1 Load balancer
- 12 V Electrical panel (Fuses - Voltmeter - Water gauge - Fuel gauge - Battery warning - Fuel warning - Water warning)
- **110v outlets & USB in the cabins**
- 1 Shore power socket
- LED lighting: Overhead lights - Reading lights - Reading light, flexible and multi-directional
- LED navigation lights: 1 Masthead light - 1 Steaming light - 1 Mooring light on masthead
- **Indirect lighting**
- **Digital battery monitoring**
- **2 x 75w solar panels**
- **Inverter**
- **Generator**
- **Fans in cabins and saloon**
- **Fusion stereo + interior loudspeakers & waterproof exterior speakers**
- **TV**
- **WIFI enabled**
- **ZEUS 3, Autopilot, Wind & Depth, VHF with AIS**
- **Underwater light**
- **Air conditioning throughout including bow cabin**

SAFETY GEAR

- **Primary and secondary anchors**
- **6 x Fenders**
- **6 x Mooring / dock lines**
- **Lifejackets and safety harnesses per max pax**
- **Safe**
- **Bell**
- **Flare kit**
- **Binoculars**
- **Navigation tools: Parallel rule, compass, dividers**

CRUISING GEAR

- **Bed linens per max pax**
- **Plates, cups, saucers, glasses per max pax**
- **Flatware per max pax**
- **Pots, pans, miscellaneous food prep**
- **Cooking utensils**
- **Coffee pot, tea, kettle, toaster**
- **Snorkeling gear per max pax**
- **Towels and washcloths per max pax**

Length Overall: 15.94m/52ft 4in
Waterline Length: 14.52m/47ft 8in
Mast Height: 21.40m/70ft 3in
Beam: 4.80m/15ft 9in
Draft: 1.92m/6ft 4in
Displacement: 13930kg/30702lb
Fuel Capacity: 400L/106gal
Water Capacity: 440L/116al
Engine Yanmar 110hp

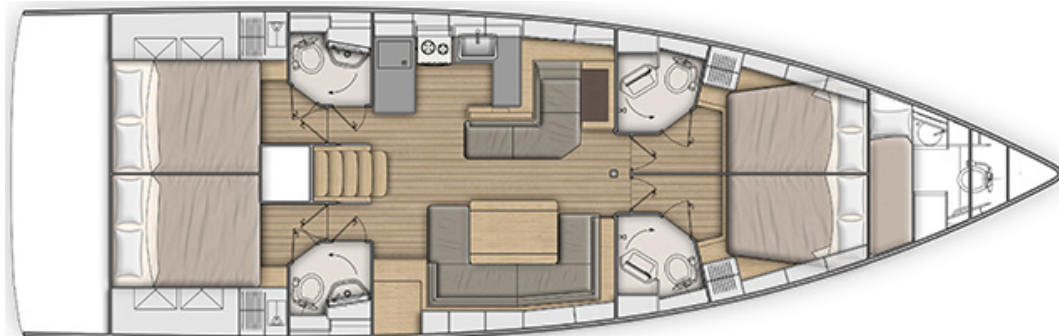

The Builder reserves the right to change or amend the contents of this document at any time without prior notification to any third party, and no liability will be accepted for errors contained within the same.